

# NOVAFLEX<sup>®</sup>

PROVIDING HOSE & DUCT SOLUTIONS



**ULTRA ABASION RESISTANT**  
**Mining Slurry Hoses**

**LARGE DIAMETER CUSTOM**  
**Material Handling Hoses**

**Novaflex®**

# Slurry King Material Handling Hose

## The solution to your hard piping problems!

Slurry-King is the tough, versatile alternative to inflexible, cumbersome steel tubing. Its easy handling and reusable quick-fastening flange system make installation a snap. So when your hard piping system is down, get up and running in minutes with Slurry-King material handling hose.

- Absorbs system vibration and saves wear on equipment
- Compensates for thermal expansion and contraction
- Reduces noise
- Flexible connection for hard piping misalignment
- Can be cut on site for immediate installation
- No welding necessary!
- Available with many inner tube compounds to meet your specific material handling needs including 'Wear Indicator' style for visual abrasion monitoring
- Available in a variety of tube gauges ranging from: 1/8", 3/16", 1/4", 5/16", 3/8", 1/2"
- Flanges available



## Specification Chart

I.D. Inch	O.D. Inch	Lining Thickness Inch	Min Bend Radius	Max Prod Lgth/FT	Working Pressure/PSI	Approx WT/FT
2	3	3/16	12	60	150	2.0
2 1/2	3 1/2	3/8	12	60	150	2.7
3	4 1/2	3/8	14	60	150	4.0
4	5 1/4	3/8	20	60	150	5.4
4 1/2	6 29/64	3/8	26	60	150	9.4
5	6 29/64	3/8	26	60	150	8.0
6	7 1/2	3/8	30	60	150	9.4
8	9 1/2	3/8	69	40	150	12.1
10	11 1/2	3/8	79	40	150	14.8
12	13 3/4	3/8	99	40	150	18.8
14	16	3/8	119	40	150	26.0

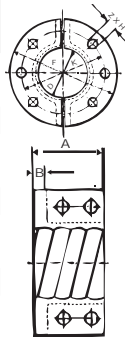

'D' I.D. Inches	'A' Inches	'B' Inches	'K' Inches	'P' Inches	'Z' Inches	'H' Inches	Approx/WT/LBS
2	3 11/32	5/8	4 3/4	6	4	3/4	3.3
2 1/2	3 5/16	5/8	5 1/2	7	4	3/4	4.4
3	3 5/16	5/8	6	7 1/2	4	3/4	4.4
4	3 5/16	5/8	7 1/2	9	8	3/4	6.6
4 1/2	4 1/8	5/8	8 1/2	10	8	7/8	7.7
5	4 1/8	5/8	8 1/2	10	8	7/8	7.7
6	4 1/2	1 1/16	9 1/2	11	8	7/8	8.8
8	5 7/8	3/4	11 3/4	13 1/2	8	7/8	13.2
10	6 7/8	1 1/8	14 1/4	16	12	1	25.4
12	7 11/16	1 1/8	17	19	12	1	30.9
14	7 11/16	1 1/8	18 3/4	21	12	1 1/8	35.3

### Slurry King Hose Specifications

#### WEAR-INDICATOR STYLE

Ideal for abrasive applications where preventative maintenance programs are in place. Slurry-King 'wear-indicator' can be disconnected on site for routine visual wear monitoring: When the alternating black and red tube compounds have worn down to the next layer the hose is simply rotated for extended life. **Disclaimer:** It is impossible to test Novaflex hose and ducting under all conditions to which it might be subjected in the field. It is therefore the buyer and/or end user's responsibility to test all Novaflex hose and ducting under conditions that duplicate the service condition prior to installation.

### Split Flange Coupling Specifications

09.2016

## IN USA

### North Carolina

449 Trollingwood Road  
Haw River, NC 27258  
tel (336)578-2161  
fax (336)578-5554  
800-334-4270

### New Jersey

1024 Industrial Drive  
West Berlin, NJ 08091  
tel (856)768-2275  
fax (856)768-2385  
800-225-0215

### Indiana

7812 Moller Road  
Indianapolis, IND 46268  
tel (317)334-1444  
fax (317)334-1535  
800-526-6288

## IN CANADA

### Ajax, Ontario

555 Beck Crescent  
Ajax, ON L1Z 1C9  
tel (905)686-5200  
fax (905) 686-8349  
800-563-3539

## IN U.K.

### Bromborough, Wirral

18 Candy Park 2, Power Road  
Bromborough, Wirral UK CH62 3QT  
tel 44(0)151-334-0873  
fax 44(0)151-334-7145

www.novaflex.co.uk Email: sales@novaflex.co.uk